

**41636 ENTERPRISE CIRCLE, SUITE C**  
TEMECULA, CA 92590

**FOR LEASE**  
**INDUSTRIAL / FLEX SPACE**



**FOR MORE INFORMATION, PLEASE CONTACT:**

**CAREY PASTOR** | Senior Vice President

(951) 297-7434 | [cpastor@cbcsocalgroup.com](mailto:cpastor@cbcsocalgroup.com)

CalDRE License # 01403298



**COLDWELL  
BANKER  
COMMERCIAL  
SC**



**41636 ENTERPRISE CIRCLE, SUITE C**  
TEMECULA, CA 92590

**FOR LEASE**  
**INDUSTRIAL / FLEX SPACE**



## PROJECT HIGHLIGHTS

- ±3,564 SF Industrial/Flex Space for Lease
- Improved office area includes:
  - Large open reception / office area
  - Large private office
  - 2 restrooms
- 18' warehouse clear height
- 12'h x 12'w rear-loading roll-up door
- 200 amp, 102/208 v, 3 phase power supply
- Warehouse lighting
- \$5,200.00 per month

# 41636 ENTERPRISE CIRCLE, SUITE C

TEMECULA, CA 92590

FOR LEASE  
INDUSTRIAL / FLEX SPACE

## AVAILABILITY

SUITE	UNIT SIZE (SF)	MONTHLY BASE RENT	DESCRIPTION
C	±3,564 SF	\$5,200.00 per month	Reception area/open office, 1 private office, 2 restrooms, balance of space warehouse with rear loading 12x12 roll up door and man door. Available June 1, 2024

## SITE PLAN

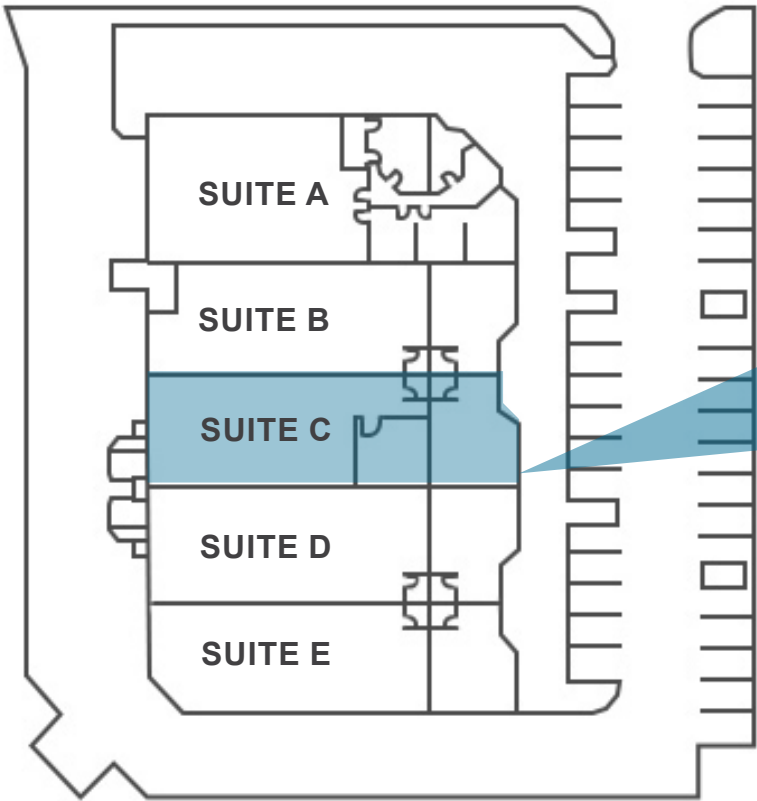

## FLOOR PLAN

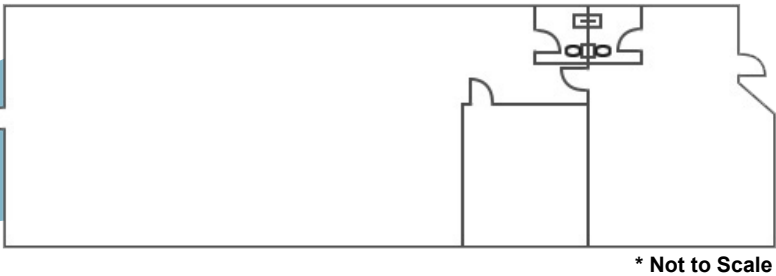

# 41636 ENTERPRISE CIRCLE, SUITE C

TEMECULA, CA 92590

FOR LEASE  
INDUSTRIAL / FLEX SPACE

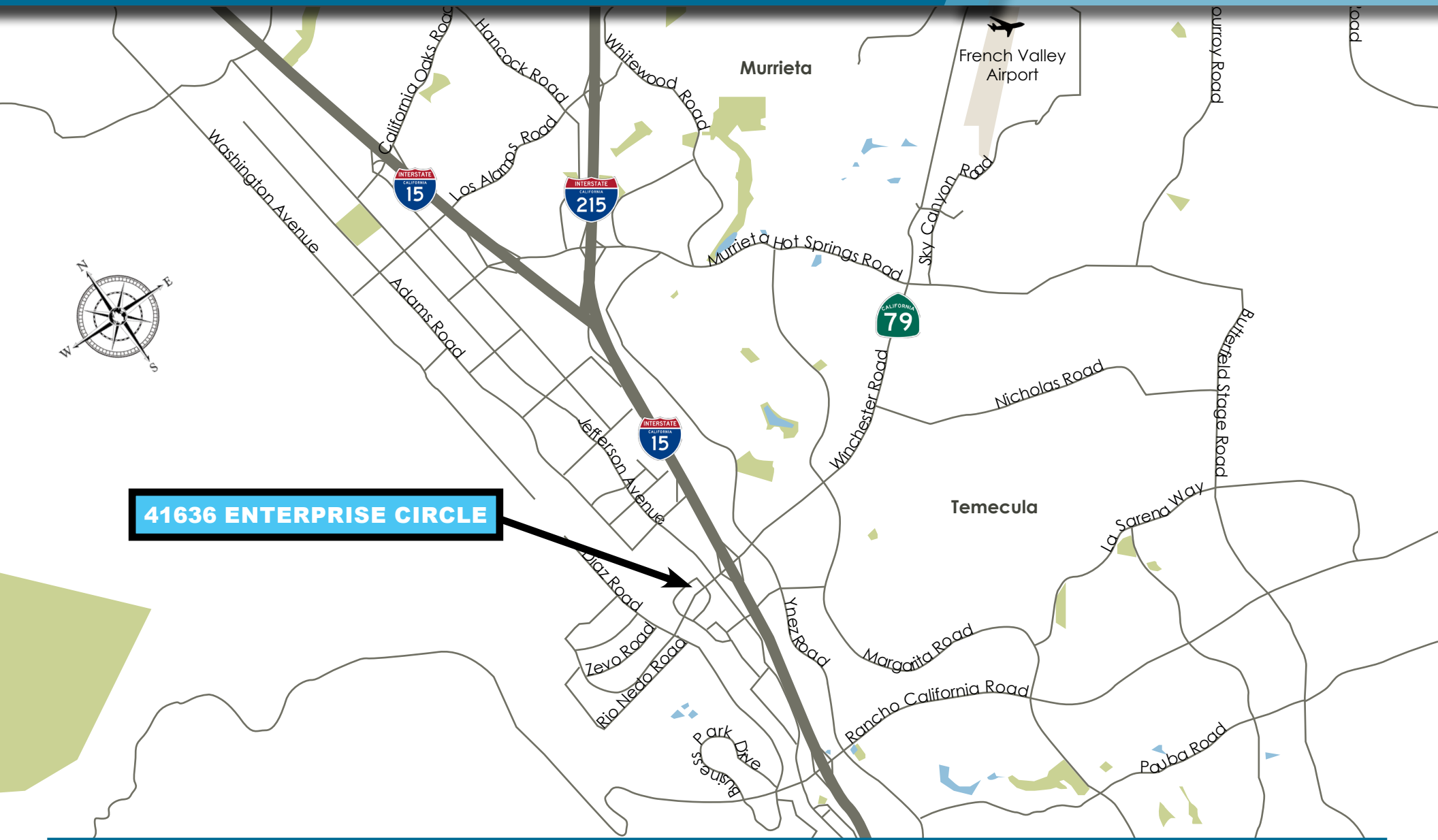



**41636 ENTERPRISE CIRCLE, SUITE C**  
TEMECULA, CA 92590

**FOR LEASE**  
**INDUSTRIAL / FLEX SPACE**



**FOR MORE INFORMATION, PLEASE CONTACT:**

**CAREY PASTOR**  
Senior Vice President  
951.297.7434  
cpastor@cbcsocalgroup.com  
CalDRE # 01403298

27368 Via Industria | Suite 102  
Temecula | California | 92590  
t 951.200.7683 | f 951.239.3147  
cbcsocalgroup.com

