

# TEMECULA CORPORATE PARK

43379-43397 BUSINESS PARK DRIVE, TEMECULA, CA 92590

**FOR LEASE**  
**INDUSTRIAL / FLEX SPACE**



**FOR MORE INFORMATION, PLEASE CONTACT:**

**CAREY PASTOR** | Senior Vice President

(951) 297-7434 | [careyp@cbcsocalgroup.com](mailto:careyp@cbcsocalgroup.com)

CalDRE License # 01403298



**COLDWELL  
BANKER  
COMMERCIAL  
SC**



# TEMECULA CORPORATE PARK

43379-43397 BUSINESS PARK DRIVE, TEMECULA, CA 92590

**FOR LEASE**  
**INDUSTRIAL / FLEX SPACE**



## PROJECT HIGHLIGHTS

- High image industrial/flex space for lease
- Located in the Rancho California Business Park
- Close proximity to the I-15 freeway via Rancho California Road
- Ample parking
- Rear loading 10' x 12' roll up doors
- Flexible floor plans

# TEMECULA CORPORATE PARK

43379-43397 BUSINESS PARK DRIVE, TEMECULA, CA 92590

## FOR LEASE

### INDUSTRIAL / FLEX SPACE

### AVAILABILITY

SUITE	UNIT SIZE (SF)	MONTHLY BASE RENT	2024 ESTIMATED MONTHLY COMMON AREA OPERATING EXPENSES (CAOE)	DESCRIPTION
43391 C-4	±1,950 SF	\$2,010.00 per month	\$818.00 per month	Reception area, 5 private offices, wet bar, restroom, balance of space open bull-pen office with 10'w x 12' h rear loading roll up door and man door
43391 C-5	±1,920 SF	\$1,980.00 per month	\$806.00 per month	Reception area, 2 private offices, wet bar, restroom, balance of space warehouse with 10'w x 12' h rear loading roll up door and man door

### C-5 FLOOR PLAN

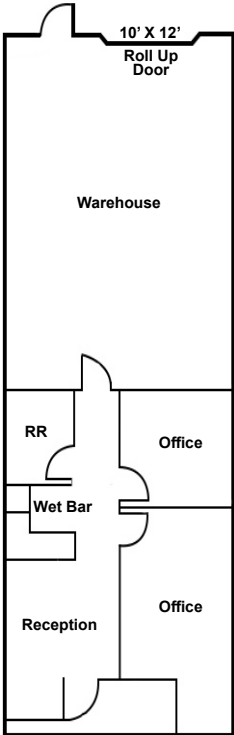

\* Not to Scale

### SITE PLAN

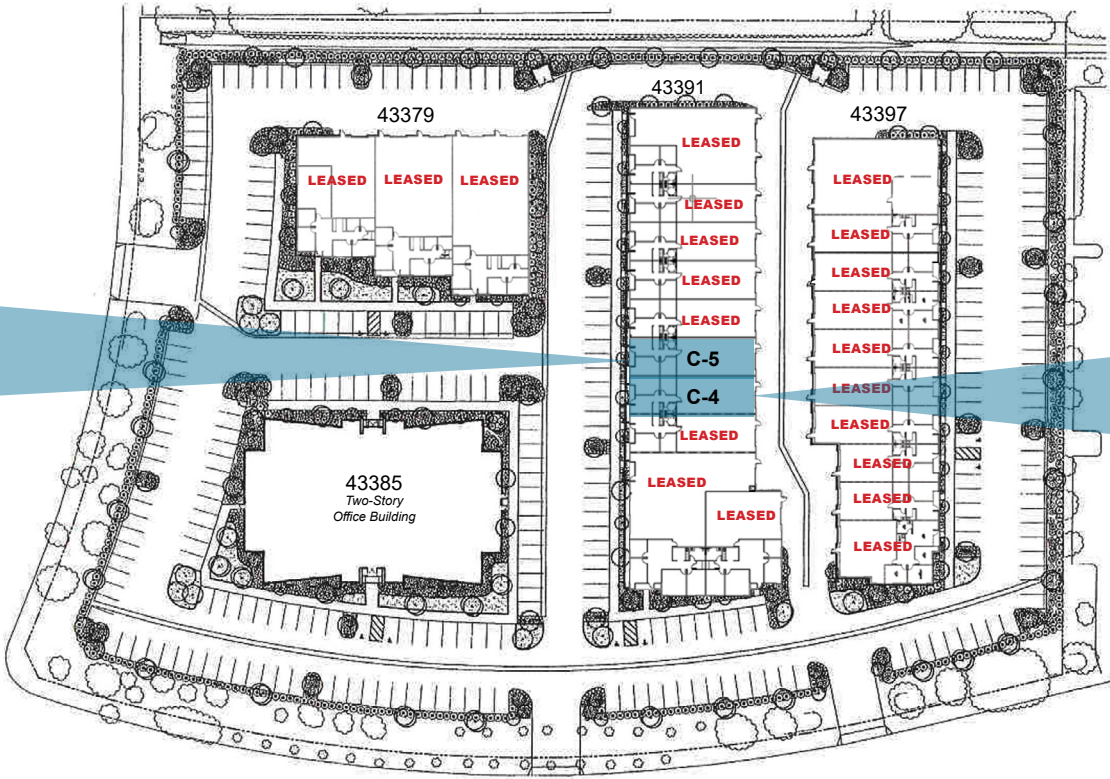

### C-4 FLOOR PLAN

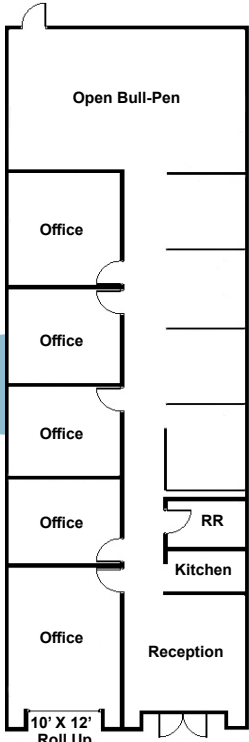

\* Not to Scale

# TEMECULA CORPORATE PARK

43379-43397 BUSINESS PARK DRIVE, TEMECULA, CA 92590

FOR LEASE

INDUSTRIAL / FLEX SPACE

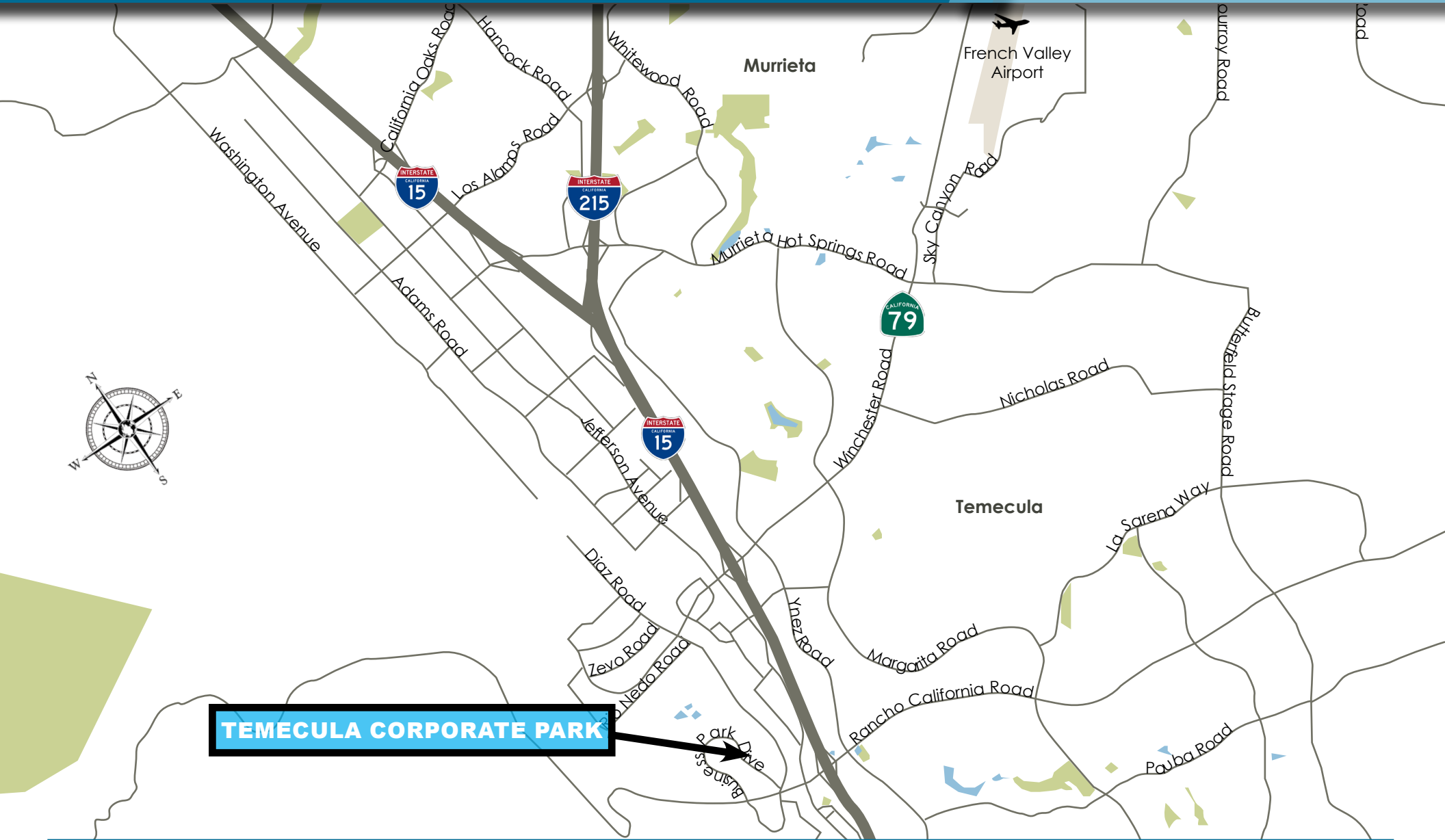

Coldwell Banker Commercial and the Coldwell Banker Commercial Logo are registered service marks licensed to Coldwell Banker Commercial Affiliates. Each Office is Independently Owned and Operated. All information contained herein has been obtained from sources deemed reliable. However, no warranty or guarantee is made as to the accuracy of the information.

CalDRE License # 02089395



# TEMECULA CORPORATE PARK

43379-43397 BUSINESS PARK DRIVE, TEMECULA, CA 92590

FOR LEASE

INDUSTRIAL / FLEX SPACE



FOR MORE INFORMATION, PLEASE CONTACT:

**CAREY PASTOR**

Senior Vice President

951.297.7434

[careyp@cbcsocalgroup.com](mailto:careyp@cbcsocalgroup.com)

CalDRE # 01403298

27368 Via Industria | Suite 102  
Temecula | California | 92590  
t 951.200.7683 | f 951.239.3147  
[cbcsocalgroup.com](http://cbcsocalgroup.com)



**COLDWELL  
BANKER  
COMMERCIAL**  
SC