

# LEASE

## OSWEGO HIGHWAY 960

960 Oswego Highway, Sumter, SC 29153



### PROPERTY DESCRIPTION

Subject property is less than a mile from US Highway 378, which spans from Conway to Columbia. Building has 4,395 square feet of office space as well as 35,605 square feet of warehouse space. +/-15,000 square feet of warehouse space has gas, heat, and central air.

### PROPERTY HIGHLIGHTS

- 7 Offices
- Show Room
- 2 Conference Rooms
- 6 Roll Up Doors
- 2 Loading Docks
- Ceiling Height: 13'2" clear / 15,000 sq ft
- Ceiling Height: 17' clear / 25,000 sq ft
- \$4.50/sq ft NNN | \$15,000/mo NNN



**Jay Davis, CCIM**  
803 934 6597

**Heather Tickel**  
803 778 1139



**COLDWELL BANKER  
COMMERCIAL  
CORNERSTONE**



# LEASE

## OSWEGO HIGHWAY 960

960 Oswego Highway Sumter, SC 29153

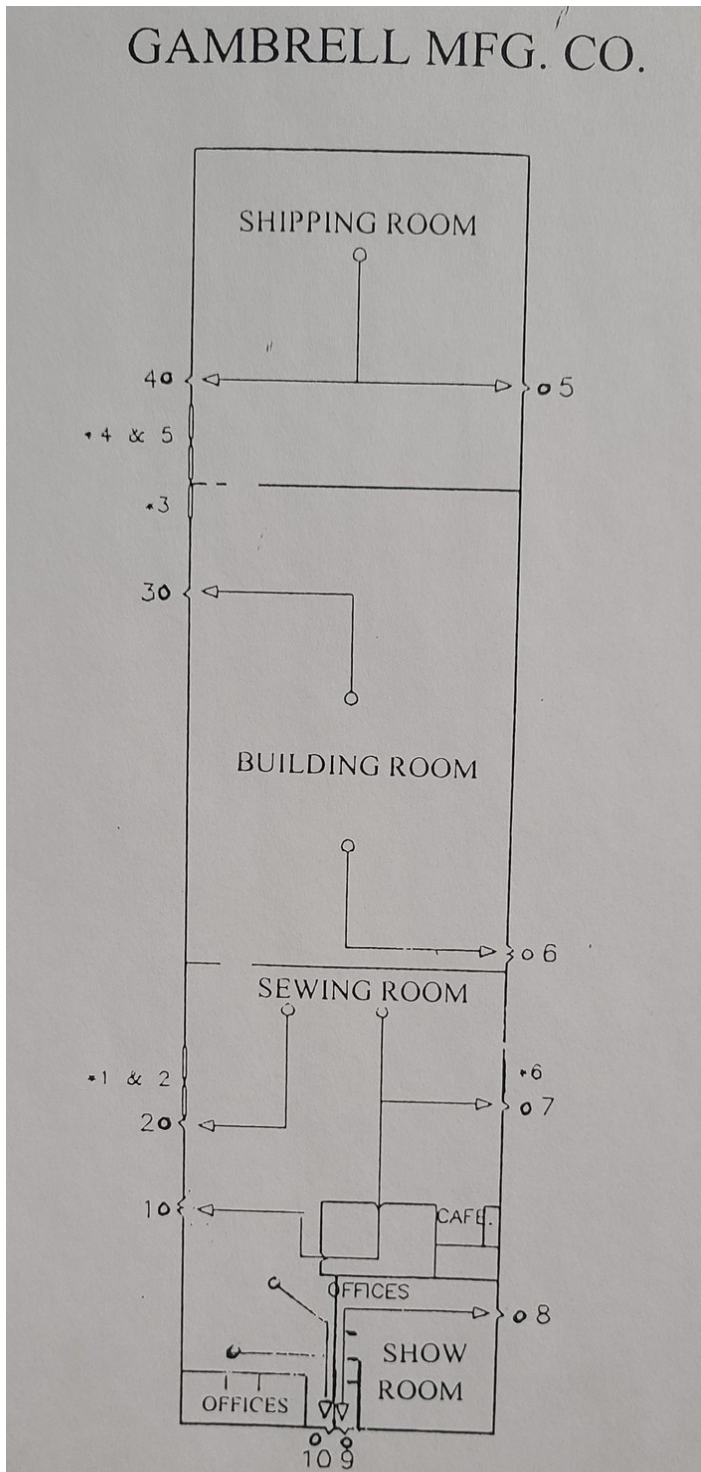

Jay Davis, CCIM  
803 934 6597

Heather Tickel  
803 778 1139



COLDWELL BANKER  
**COMMERCIAL**  
CORNERSTONE