

FOR SALE

668 Marina Drive | Charleston, SC



COLDWELL BANKER
COMMERCIAL
ATLANTIC



OFFERING SUMMARY

Price:	\$479,000
Total Available:	2,000 SF
County:	Berkeley County
Tax ID:	271-10-01-021
Suite:	Office Building, Unit D

PROPERTY OVERVIEW

Great 2nd floor office space on Daniel Island. Conveniently located off Clements Ferry Road with quick access to 526. Little thru traffic and close to Daniel Island Marina. For sale - call agent for more information or to schedule a showing.



COLDWELL BANKER
COMMERCIAL
ATLANTIC

668 Marina Drive | Charleston, SC 29492

Steve Hund • shund@cbcatlantic.com

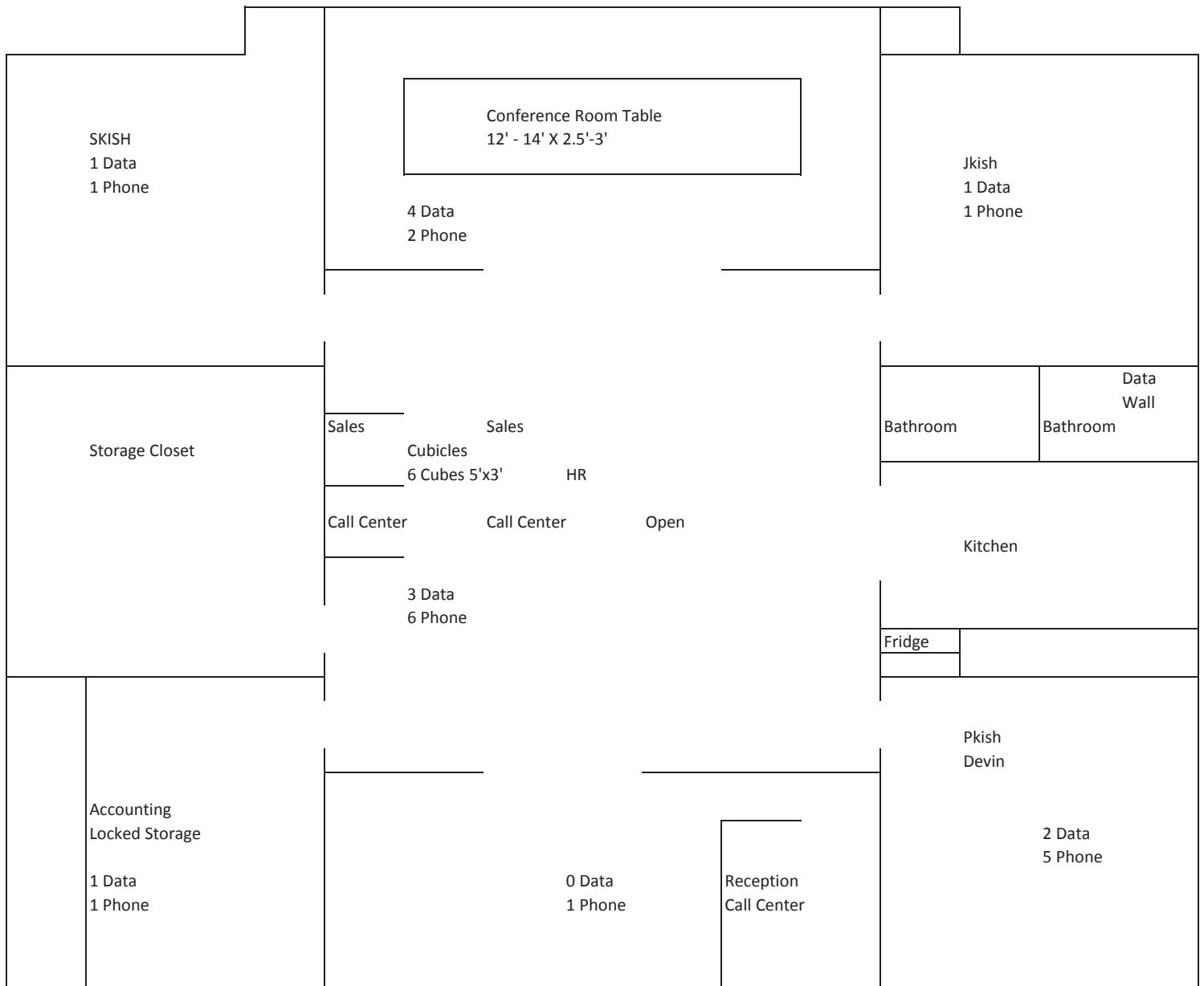

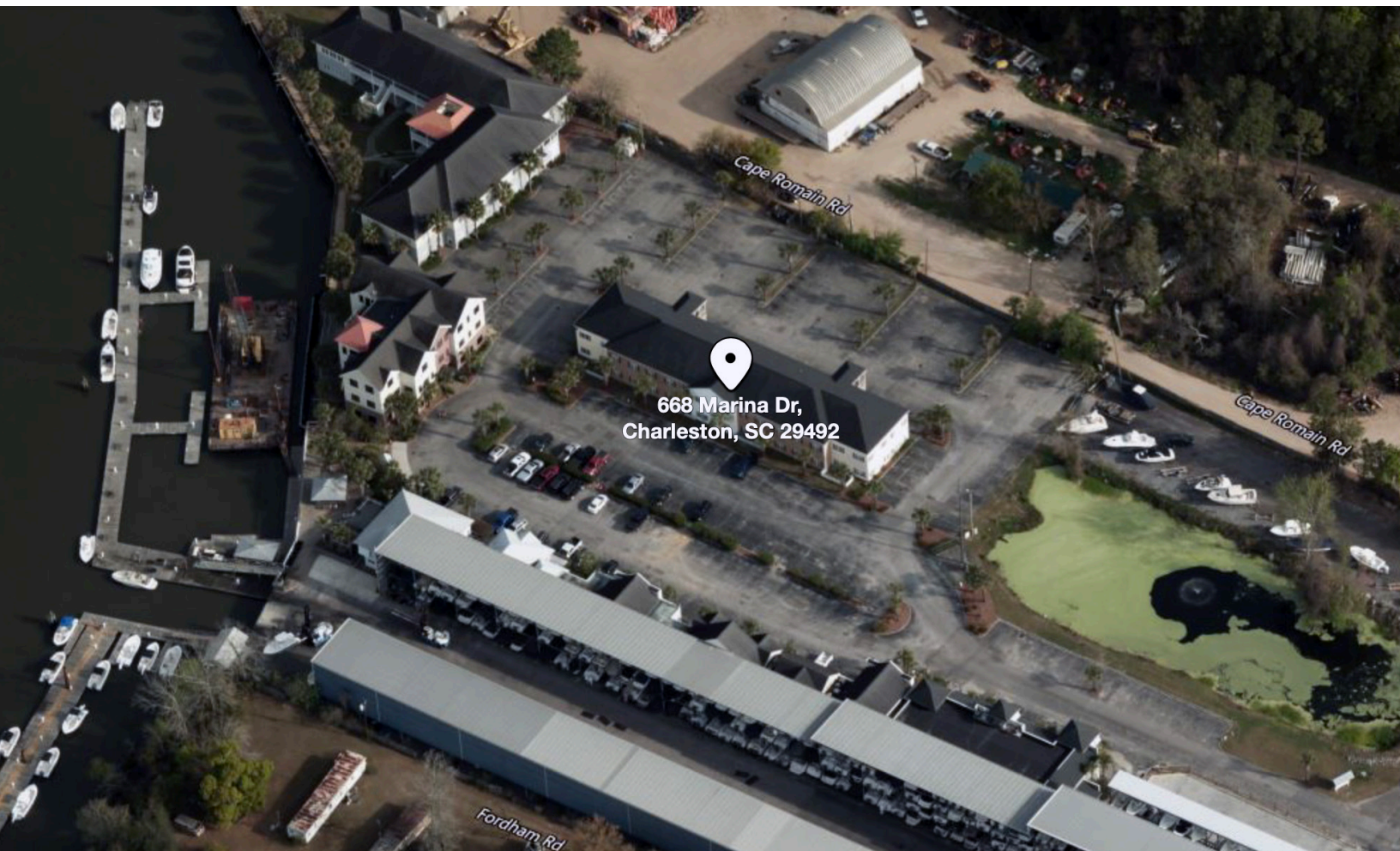

COLDWELL BANKER
COMMERCIAL
ATLANTIC

668 Marina Drive | Charleston, SC 29492

Steve Hund • shund@cbcatlantic.com

Demographics

1 Mile

3 Miles

5 Miles

Total Population: 1,609 16,841 64,365

Total Households: 734 7,649 27,044

Average HH Income: \$148,671 \$161,632 \$104,303



3,471

Businesses
within 5 Miles



49,902

Employees
within 5 Miles

668 Marina Dr, Charleston, South Carolina, 29492

2023 Average Household Income by Block Groups



5 km

2 mi

64,365

Population
within 5 Miles

All demographics based on Esri forecasts for 2023



COLDWELL BANKER
COMMERCIAL
ATLANTIC

668 Marina Drive | Charleston, SC 29492

Steve Hund • shund@cbcatlantic.com



COLDWELL BANKER
COMMERCIAL
ATLANTIC

668 Marina Drive | Charleston, SC 29492

Steve Hund • shund@cbcatlantic.com

Steve Hund
(C) 843.990.2417
shund@cbcatlantic.com

3506 W Montague Ave Suite 200
North Charleston, SC 29418
843.744.9877
cbcatlantic.com | cbcretailatlantic.com



**COLDWELL BANKER
COMMERCIAL
ATLANTIC**

This information has been obtained from sources believed reliable but has not been verified for accuracy or completeness. Coldwell Banker Commercial Atlantic makes no guarantee, representation or warranty and accepts no responsibility or liability as to the accuracy, completeness, or reliability of the information contained herein. You should conduct a careful, independent investigation of the property and verify all information. Any reliance on this information is solely at your own risk.

The information contained herein should be considered confidential and remains the sole property of Coldwell Banker Commercial Atlantic at all times. Although every effort has been made to ensure accuracy, no liability will be accepted for any errors or omissions. Disclosure of any information contained herein is prohibited except with the express written permission of Coldwell Banker Commercial Atlantic.