

# LEASE

## WESMARK BOULEVARD 170 EAST

170 E. Wesmark Boulevard Sumter, SC 29150



### PROPERTY DESCRIPTION

Located on the corner of East Wesmark Boulevard and South Pike West, this space has excellent visibility with easy road access. Subject space is just east of Broad Street, which houses many Sumter businesses and neighbors a major highway, US 378.

### PROPERTY HIGHLIGHTS

- AADT: Wesmark 4,500
- AADT: Pike 7,300
- High visibility

### OFFERING SUMMARY

Lease Rate:	\$7,136.25 per month (NNN)
Building Size:	5,190 SF
Zoning:	General Commercial
APN:	203-00-06-025

DEMOGRAPHICS	1 MILE	3 MILES	5 MILES
Total Households	1,787	12,260	23,534
Total Population	3,740	25,749	52,141
Average HH Income	\$41,197	\$57,700	\$56,610

**Jay Davis, CCIM**

803 934 6597

[jdavis@cbccornerstone.com](mailto:jdavis@cbccornerstone.com)

**Heather Tickel**

803 778 1139

[htickel@cbccornerstone.com](mailto:htickel@cbccornerstone.com)



**COLDWELL BANKER  
COMMERCIAL  
CORNERSTONE**

# LEASE

## WESMARK BOULEVARD 170 EAST

170 E. Wesmark Boulevard Sumter, SC 29150

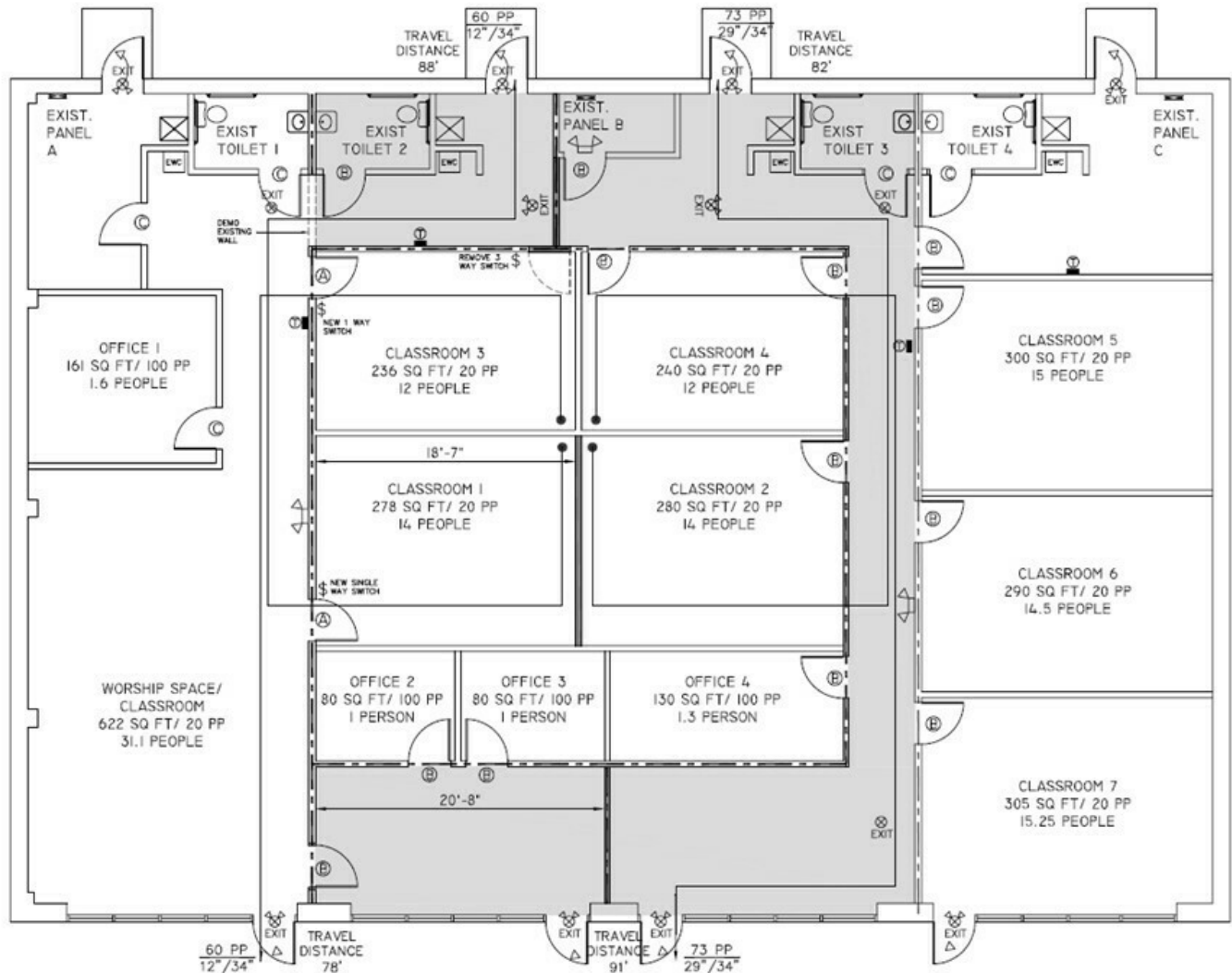

FLOOR PLAN AND LIFE SAFETY PLAN

SCALE: 1/4" = 1'-0"

Jay Davis, CCIM

803 934 6597

jdavis@cbccornerstone.com

Heather Tickel

803 778 1139

htickel@cbccornerstone.com



COLDWELL BANKER  
**COMMERCIAL**  
CORNERSTONE

# LEASE

## WESMARK BOULEVARD 170 EAST

170 E. Wesmark Boulevard Sumter, SC 29150



Jay Davis, CCIM  
803 934 6597  
jdavis@cbccornerstone.com

Heather Tickel  
803 778 1139  
htickel@cbccornerstone.com



COLDWELL BANKER  
**COMMERCIAL**  
CORNERSTONE

# LEASE

## WESMARK BOULEVARD 170 EAST

170 E. Wesmark Boulevard Sumter, SC 29150

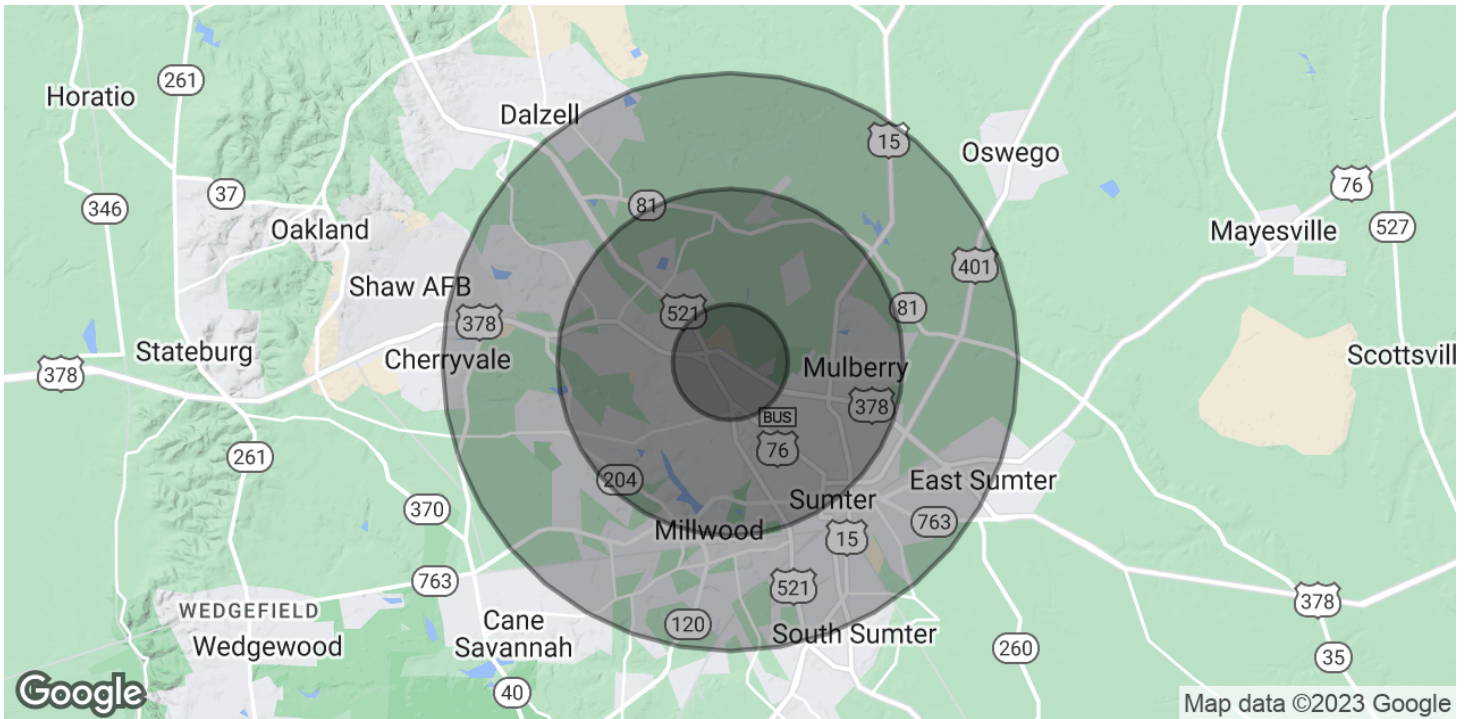

### POPULATION

	1 MILE	3 MILES	5 MILES
Total Population	3,740	25,749	52,141
Average Age	38.8	39.8	37.5
Average Age (Male)	38.5	36.6	34.4
Average Age (Female)	42.3	43	40.1

### HOUSEHOLDS & INCOME

	1 MILE	3 MILES	5 MILES
Total Households	1,787	12,260	23,534
# of Persons per HH	2.1	2.1	2.2
Average HH Income	\$41,197	\$57,700	\$56,610
Average House Value	\$70,790	\$123,096	\$123,494

\* Demographic data derived from 2020 ACS - US Census

**Jay Davis, CCIM**

803 934 6597

[jdavis@cbccornerstone.com](mailto:jdavis@cbccornerstone.com)

**Heather Tickel**

803 778 1139

[htickel@cbccornerstone.com](mailto:htickel@cbccornerstone.com)



**COLDWELL BANKER  
COMMERCIAL  
CORNERSTONE**